

Regionale
20

Eine Karte
-35/65+

23.11.2019–
19.1.2020

To what extent does a place play a role in artistic creation? The annual Regionale has a pre-determined focus on a specific location and geography. Since its inception twenty years ago, this is a unique premise for an exhibition project at the center of Europe, uniting three countries, their histories and traditions: Germany, France, and Switzerland.

Correspondingly, does age, beyond the biographical, play a role in artistic creation? For the exhibition *Eine Karte -35/65+* (Engl. A Map -35/65+) and based on this question, works by artists of a specific age-range were selected: those under 35 and those over 65. The exhibition thus becomes an inventory that controversially relies on demographics and biographies to interrupt the familiar continuum that typically guides exhibition making—which often either focuses on a single generation or several related generations—all the better to open up alternative perspectives.

Annette Barcelo

* 1943 Basel, CH; lives and works in Basel.

Selina Baumann

* 1988 Wattwil, CH; lives and works in Basel, CH.

Camille Brès

* 1987 Maisons-Laffitte, FR; lives and works in Strasbourg, FR.

Peter Brunner-Brugg

* 1946 Brugg, CH; lives and works in Basel, CH.

Jorinde Fischer

* 1990 Schwäbisch Hall, DE; lives and works in Berlin and Karlsruhe, DE.

Pierre-Charles Flipo

* 1987 Fontainebleau, FR; lives and works in Dijon, FR.

Gerome Johannes Gadiant

* 1996 Basel, CH; lives and works in Basel.

Hannah Gahlert

* 1988 in Karlsruhe, DE; lives and works in Karlsruhe.

Vincent Gallais

* 1991 Brétigny-sur-Orge, FR; lives and works in Strasbourg, FR.

Danae Hoffmann

* 1994 Neustadt an der Weinstrasse, DE; lives and works in Karlsruhe, DE.

Géraldine Honauer

* 1986 Aarau, CH; lives and works in Basel, CH.

Rebecca Kunz

* 1986 Bern; lives and works in Basel, CH, and Bern.

Marie-Louise Leus

* 1948 Basel, CH; lives and works in Therwil, CH.

Catrin Lüthi K

* 1953 Scuol, CH; lives and works in Riehen, CH.

Marie Matusz

* 1994 Toulouse, FR; lives and works in Basel, CH.

Guido Nussbaum

* 1948 Muri, CH; lives and works in Basel, CH.

Mirjam Plattner

* 1993 Reigoldswil, CH; lives and works in Basel, CH.

Lisa Schittulli

* 1990 Bagnolet, FR; lives and works in Paris and Strasbourg, FR.

Jürg Stäuble

* 1948 Wohlen, CH; lives and works in Basel, CH.

Werner von Mutzenbecher

* 1937 Frankfurt a. M., DE; lives and works in Basel, CH.

Alfred Wirz

* 1952 Aarau, CH; lives and works in Montmelard, FR.

Jürg Stäuble
 1 *Form, Kreisraster gefächert*, 2019
 Aluminum
 143 × 160 × 3 cm
 2 *K24 D15*, 1999/2008
 Car paint, wood
 97.5 × 80 × 3 cm
 3 *Beidseits 2/4*, 2007
 Mother-of-pearl lacquer, XPS epoxy resin
 58 × 114 × 8 cm
 4 *Beidseits 3/10*, 2006
 Mother-of-pearl lacquer, XPS epoxy resin
 58 × 238 × 8 cm
 5 *Beidseits 2/2*, 2007
 Mother-of-pearl lacquer, XPS epoxy resin
 58 × 54 × 8 cm
 6 *Beidseits 3/9*, 2007
 Mother-of-pearl lacquer, XPS epoxy resin
 58 × 174 × 8 cm
 All works courtesy of the artist and Galerie Mark Müller, Zurich

Gerome Johannes Gadiant
 7 *ubiquitous instants. (questioning time with Roland Buser)*, 2019
 Sound installation
 60'
 Dimensions variable

Mirjam Plattner
 8 *headed*, 2019
 Polyethylene foil
 Approx. 8 × 1.5 × 1.5 m

Marie Matusz
 9 *Storytellers*, 2017/2019
 Ash, fire gel, glass, metal
 Dimensions variable

Marie-Louise Leus
 1 *297 Sonnen*, 2019
 74 × 65 cm
 2 *370 Monde*, 2019
 74 × 65 cm
 3 *Aus „Brief an eine Freundin“, Afghanistan*, 25.11.2018
 60 × 60 cm
 4 *Scharlach*, 2019
 53 × 65 cm
 5 *Aus „Brief an eine Freundin“, La Rambla*, 2017/18
 60 × 67 cm
 6 *Aus „Brief an eine Freundin“, Strassbourg*, 12.12.2018
 60 × 66 cm
 7 *Brief an eine Freundin*, 2019
 127 × 42 cm
 All works ink on transparent foil

Géraldine Honauer
 8 *De-icing salt borrowed from Schweizer Salinen AG in Pratteln*, 23.11.2019–19.1.2020
 Salt
 Adjusted to the given space

Marie-Louise Leus
 9 *Brief an eine Freundin*, 2018/19
 127 × 112 cm
 10 *Insalata Mista*, 2019
 127 × 112 cm
 All works ink on transparent foil

Lisa Schittulli
 1 *Puma Lisa*, 2019
 2 *La visite*, 2019
 3 *Untitled*, 2019
 4 *Langue de P*****, 2019
 5 *Untitled*, 2019
 6 *Untitled*, 2019
 7 *Gullisa enchainée*, 2019
 8 *Untitled*, 2019
 9 *Krampus Night*, 2019
 10 *Sautes d'humeur capillaire*, 2019
 All works graphite on paper
 45.5 × 38 cm
 Danae Hoffmann
 11 *Parallele Welten*, 2019
 Fabric, felt, filling material
 2 parts, 78 × 77 × 41 cm, 112 × 55 × 27 cm

Lisa Schittulli
 12 *A Journey : Map #3*, 2014/2015
 13 *A Journey : Map #1*, 2014/2015
 14 *A Journey : Map #2*, 2014/2015
 15 *A Journey : Map #4*, 2014/2015
 All works mixed media on paper
 149 × 105 cm
 Annette Barcelo
 16 *Schön zu sehen*, 2017/19
 83.5 × 49 cm
 17 *Bleib noch ein Weilchen*, 2016
 75.5 × 56 cm
 18 *Nahezu ein Idyll*, 2016
 75.5 × 56 cm
 19 *Machen Sie sich keine Sorgen*, 2019
 25 sheets, in total 190 × 400; single sheet 85 × 30 cm
 All works acrylic and charcoal on paper

Rebecca Kunz
 20 *Untitled*, 2016
 Earth, white glue, wire
 29 × 16 × 13 cm
 Pierre-Charles Flipo
 21 *Plaster by fire (fire pit VIII)*, 2019
 Metal
 100 × 67 × 20 cm
 22 *Plaster by fire (fire pit V)*, 2019
 Brass
 22 × 17 × 11 cm
 23 *Plaster by fire (fire pit)*, 2018
 Metal
 70 × 70 × 20 cm

Danae Hoffmann
 24 *Tender*, 2019
 Mixed media
 5 parts, 215 × 31 × 100 cm, 170 × 36 × 82 cm, 194 × 35 × 45 cm, 275 × 71 × 70 cm, 120 × 24 × 23 cm
 Hannah Gahlert
 25 *HUNGER*, 2019
 Ceramic
 6 parts,
 50 × 36 × 50 cm, 40 × 35 × 53 cm, 43 × 37 × 68 cm, 55 × 43 × 58 cm, 44 × 31 × 55 cm, 35 × 41 × 52 cm

Selina Baumann
 26 *Orbs*, 2019
 Approx. 80 × 50 × 50 cm
 27 *Ylva*, 2019
 Approx. 165 × 45 × 45 cm
 28 *Arlík*, 2019
 Approx. 90 × 55 × 40 cm
 29 *Flare*, 2019
 Approx. 160 × 35 × 35 cm
 30 *Holo*, 2019
 Approx. 175 × 20 × 20 cm
 31 *Faro*, 2019
 Approx. 80 × 60 × 60 cm
 32 *Wide*, 2019
 Approx. 180 × 30 × 25 cm
 33 *Kula*, 2019
 Approx. 100 × 52 × 52 cm
 34 *Meder*, 2019
 Approx. 175 × 45 × 45 cm
 All works ceramic

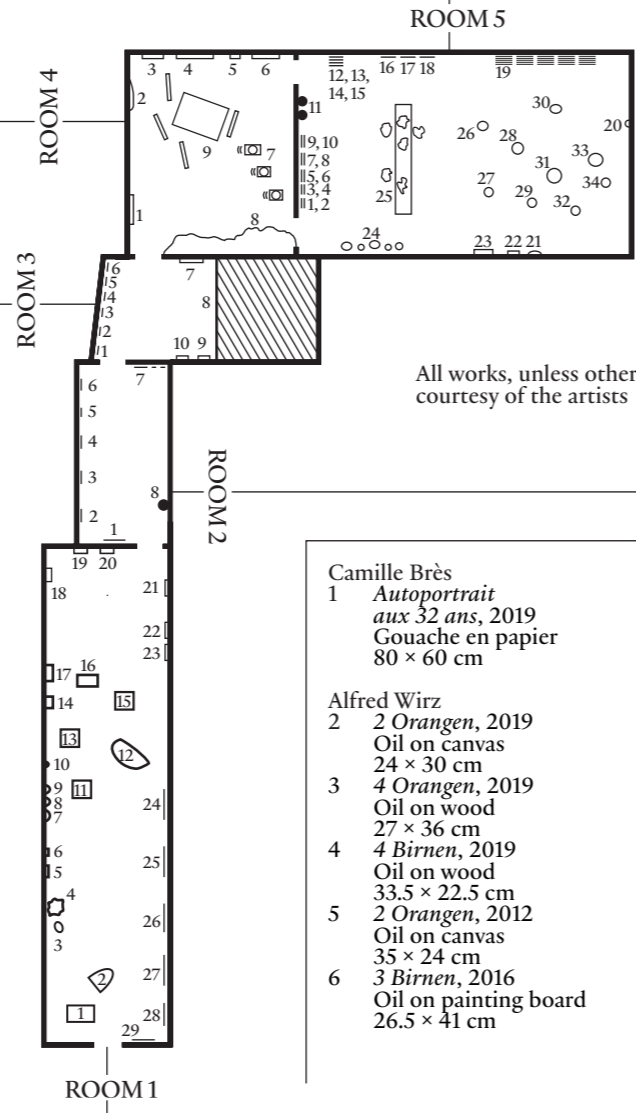

LIBRARY
 (available only during special opening hours)

Géraldine Honauer
White A4 paper sheets continuously copied at the Kunsthalle Basel office until they are black, 2019
 110 B/W photocopies on copy paper
 21 × 29.7 × 1.5 cm
 In the library since 23.11.2019, available for lending

As is the tradition with the annual Regionale exhibitions, works are for sale. Please ask the front desk for a price list, if interested.

Camille Brès
 1 *Autoportrait aux 32 ans*, 2019
 Gouache en papier
 80 × 60 cm

Alfred Wirz
 2 *2 Orangen*, 2019
 Oil on canvas
 24 × 30 cm
 3 *4 Orangen*, 2019
 Oil on wood
 27 × 36 cm
 4 *4 Birnen*, 2019
 Oil on wood
 33.5 × 22.5 cm
 5 *2 Orangen*, 2012
 Oil on canvas
 35 × 24 cm
 6 *3 Birnen*, 2016
 Oil on painting board
 26.5 × 41 cm

Guido Nussbaum
 7 *Weltwand*, 2019
 Consisting of
Ulan Bator, Ø 41.7 cm
5 Africas, Ø 31 cm
FD additive, Ø 48.4 cm
Eurasika, Ø 23.8 cm
Neu Amsterdam, Ø 19.8 cm
Mediterran, Ø 19.8 cm
lindgrüner Pazifik, Ø 26.5 cm
Zwei Glanzlichter Südl. Pazifik, Ø 31 cm
Condamnation, Ø 43 cm
Grün-rot, Ø 19.3 cm
Cubaluminosa, Ø 30.1 cm
Bouvet-1, Ø 27.7 cm
Macquarie-Insel, Ø 60.5 cm
Ostlich von Seattle, Ø 33.8 cm
Nord Amsterdam, Ø 19.4 cm
WKT Mary Byrd, Ø 32 cm
WKT don't cry for me, Ø 35 cm
Sta. Ines, Ø 30 cm

Zwischen Australien und Antarktis, Ø 16.6 cm
Atelierfenster, Ø 33.5 cm
4× Afrika, Ø 16.3 cm
Seychellen, Ø 19 cm
3 Kontinents identiques, Ø 36 cm
Madagaskar Süd, Ø 19.7 cm
Vor Halifax, Ø 15 cm
Nördlich der Beringstrasse, Ø 14.9 cm
Tonga Insel, Ø 26.5 cm
Violetter Pazifik, Ø 13.2 cm
Aralsee, Ø 55.9 cm
Irkutsk, Ø 30.6 cm
WKT mit Glanz über Rockhampton, Ø 27 cm
29 auf einen Schlag, Ø 125 cm
 All works oil and mixed media on canvas

Rebecca Kunz
 8 *Untitled*, 2019
 Clay
 86 × 39 × 39 cm

Vincent Gallais
 1 *Steles Series: Wall*, 2019
 Mixed media, nails, paper
 200 × 200 × 200 cm
 2 *Steles Series: Shelter*, 2019
 Magnets, mixed media, paper
 200 × 200 × 150 cm
 Pierre-Charles Flipo
 3 *Plaster by fire (stone V)*, 2019
 Gypsum
 28 × 18 × 15 cm
 4 *Plaster by fire (fire pit X)*, 2019
 Ceramic
 35 × 35 × 25 cm
 5 *Plaster by fire (fire pit IX)*, 2019
 Metal
 51 × 30 × 15 cm

6 *Plaster by fire (fire pit IV)*, 2019
 Metal
 25 × 15 × 15 cm
 7 *Plaster by fire (fire pit III)*, 2019
 Ceramic
 20 × 18 × 9 cm
 8 *Plaster by fire (fire pit II)*, 2019
 Ceramic
 11 × 11 × 12 cm
 9 *Plaster by fire (carved III)*, 2019
 Gypsum
 12 × 8 × 7 cm

Rebecca Kunz
 10 *Untitled*, 2019
 Taxidermied house sparrows
 13 × 27 × 19 cm
 Catrin Lüthi K
 11 *Grosse Insel*, 2019
 Acrylic varnish, cardboard, gypsum, polystyrene, wood
 63 × 50 × 47 cm
 12 *Offenes Gefäss, geschichtet*, 2018
 Concrete, wood
 82 × 110 × 62 cm
 13 *Glasmöbel*, 2018
 Glass, hinge, wood
 85.5 × 51.5 × 61.3 cm
 14 *Holzhaus, Fundstück*, 2019
 Birch wood
 29.5 × 25.5 × 16.5 cm

15 *Sockel*, 2019
 Acrylic varnish, plywood, steel, wood
 152.5 × 62.5 × 56.8 cm
 16 *Bruchstück*, 2019
 Acrylic paint, concrete, stucco marble, polystyrene, wood
 125 × 59 × 52.7 cm
 17 *Lattenzeichnung*, 2019
 Shellac, string, wood
 191 × 60 × 36 cm

Peter Brunner-Brugg
 18 *Kopfleiste*, 2019
 Corrugated paper, hinge bars
 185 × 45 × 20 cm
 19 *Sediment*, 2019
 Corrugated paper, decorated paper
 106 × 75 × 10 cm

20 *Spießrutenlauf*, 2017
 Corrugated paper
 120 × 85 × 5 cm
 Jorinde Fischer
 21 *Untitled*, 2019
 Foam, latex, rubber band, textile
 2 parts, dimensions variable
 22 *Soft Pull_4*, 2019
 Glass, latex, lead band, rubber band
 250 × 70 × 10 cm
 23 *Soft Pull_3*, 2019
 Glass, latex, lead band, rubber band
 250 × 70 × 10 cm

Werner von Mutzenbecher
 24 *Turn around VI*, 2019
 180 × 180 cm
 25 *Initialen WvM*, 2019
 180 × 180 cm
 26 *turn around IV*, 2019
 180 × 180 cm
 27 *turn around V*, 2019
 180 × 180 cm
 28 *Hashtag II*, 2019
 180 × 120 cm
 29 *Hashtag I*, 2019
 180 × 120 cm
 All works acrylic on cotton
 Courtesy of the artist and Galerie Gisèle Linder, Basel

Through this roundup, the exhibition brings together twenty-one artistic positions from various locales and two age groups that newly map the significance of place and age. As a result, new narratives emerge and visitors are invited to develop their own stories and attendant maps. This leads to a series of experimental setups that do not lay claim to any coherence, but allow for contradictions, are perhaps even provocative, or may seem unorthodox and incorrect, as well as arbitrary and surprising. This cartography is one of heterogeneity that is difficult to predict and presage.

This curatorial concept also provides space for self-reflection on how one, as a curator, reacts to such diverse works of art. Having been a co-initiator of the Regionale twenty years ago and having acted as Kunsthalle Basel's director from 1996 to 2002, this exhibition for me also represents an autobiographical exercise that is strongly linked to my own artistic and curatorial experiences. These latter experiences transformed with every change in the field of work—and they are, ultimately, just as permeated by said heterogeneity, generated by unexpected continua.

At first glance, there appear to be strong similarities between the works of the two groups, older and younger. On closer examination it becomes clear, however, that the various strategies must be considered in a more differentiated manner. On the one hand, the working methods of the older generation seem to be still firmly anchored in modernism, and on the other hand, these protagonists hail from a field of practice in which a critique of modernism has been pursued since the 1980s. This resulted, as we know today, in a more expanded artistic field that made possible the globality of today's visual art.

The younger generation's practice seems to decidedly set itself apart from this approach. Mobility is different today and subject to different conditions, both in terms of personal mobility and in terms of art. Multifarious themes and varied forms of expressions emerge, and the classical dichotomies of modernism seem to have been overcome. While their historical charge is not ignored, materials and the way they are used have been liberated from any dogmas. Subject matters also have changed, for, after all, the world is a different place today than what it once was. It is remarkable to what extent these developments were already anticipated by a much older generation that introduced artistic practices

that are now being further developed by much younger practitioners with a great deal of self-understanding.

The exhibition opens with Peter Brunner-Brugg (* 1946), Jorinde Fischer (* 1990), Pierre-Charles Flipo (* 1987), Vincent Gallais (* 1991), Catrin Lüthi K (* 1953), Rebecca Kunz (* 1986), and Werner von Mutzenbecher (* 1937), all of whom, in their own ways, attempt to capture the here and now through different material and spatial constellations. The second exhibition room focuses on painting with works by Camille Brès (* 1987), Guido Nussbaum (* 1948), and Alfred Wirz (* 1952) offering different perspectives onto the self and the representation of the world, while using minimal, reduced means. In the third space, the pure materiality of Géraldine Honauer's (* 1986) monochrome salt installation meets the delicate and lucid abstractions of Marie-Louise Leus (* 1948). Material, sound, and form are put into play in the fourth room by the works of Gerome Johannes Gadiant (* 1996), Marie Matusz (* 1994), Mirjam Plattner (* 1993), and Jürg Stäuble (* 1948). In the final room, the works of Annette Barcelo (* 1943), Selina Baumann (* 1988), Hannah Gahlert (* 1988), Danae Hoffmann (* 1994), and Lisa Schittulli (* 1990) demonstrate how, through the repeated appearance of certain motifs, astonishing correspondences and associations emerge.

– Peter Pakesch

Kunsthalle Basel/Basler Kunstverein is generously supported by Kanton Basel-Stadt.



Thanks to Silke Baumann, Michaela Leutzendorff Pakesch, Claudia Müller, Andreas Reuter, Martin Stoecklin, Melina Wilson, all partners of Regionale, and to all participating artists

GUIDED TOURS THROUGH THE EXHIBITION

Every Sunday at 3 pm guided tour, in German

24.11.2019, Sunday, 11:30 am
Curator's tour with Peter Pakesch, in German

EDUCATION / PUBLIC PROGRAMS

Artists' talks
5.12.2019, Thursday, 6:30 pm
Artists' talk with Mirjam Plattner and Jürg Stäuble, in German
12.12.2019, Thursday, 6:30 pm
Artists' talk with Annette Barcelo and Selina Baumann, in German, followed by a live listening session by Gerome Johannes Gadiant (duration approx. 60 minutes)
The artists' talks are part of the art education project *Perspektive Kunstvermittlung*, and are conducted by students from the the Department of Art History of the University of Basel.

Basel Museums Night
17.1.2020, Friday, 6 pm–2 am
Special program with a live listening session by Gerome Johannes Gadiant at 11 pm as well as the sculpture workshop *Stein um Stein*

Follow us on Facebook and Instagram and share your photos and impressions with #kunsthallebasel and #regionale20.

Additional information is available at kunsthallebasel.ch

Eine Karte -35/65+ is part of Regionale 20 and is curated by Peter Pakesch on the invitation of Kunsthalle Basel to celebrate the 20th anniversary of Regionale.

Regionale brings together eighteen institutions from three countries (CH, DE, FR) presenting artistic positions from the Basel region and the tri-national area (Northwestern Switzerland, South Baden, Alsace). More information on the Regionale and the participating institutions is available at: regionale.org.